



PHOTOSHOP TEXT TEST REVIEW SHEET

To prep for your test, you should be sure you know how to accomplish the following. As you prepare, create a document.

1. Insert vertical  and horizontal  text

2. Modify kerning (spacing between two letters) or tracking (spacing between all letters in a block of text) of letters 

3. Modify scale of letters (stretch/smash horizontally or vertically) 

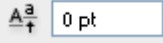
4. Modify baseline/position of letters 

5. Add type to a drawn path (draw on new layer; Control+Click thumbnail to select object; create path in Paths palette; can eyeball path off after adding text)



6. Create clipping mask (text inside letter or shape; hold alt and click between layers; box of text goes on top); no path required

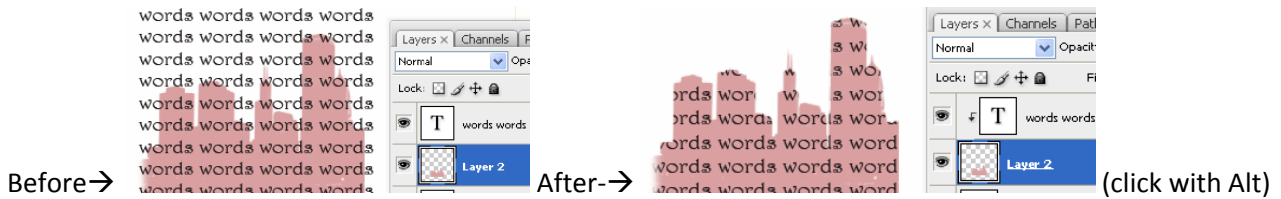

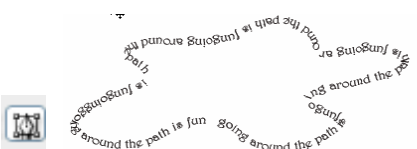
7. Add type around a shape path 

8. Remove fill from letters with stroke (HINT: Reduce fill on layers palette to zero)

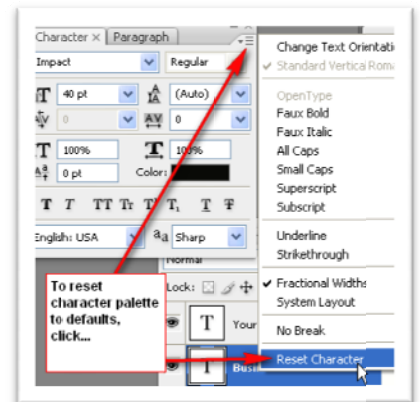
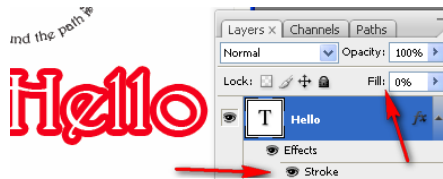

9. Add inner or outer glow to letters

10. Add gradient overlay or pattern overlay to letters



11. Warp or distort text (remember, must rasterize text first; magic wand letter/Layer—New via Cut, then Edit, Transform)

